

# DESIGNER SERIES DOORS INSTALLATION GUIDE



Designer Series Doors & Drawers are configurable both Vertically & Horizontally, follow these steps for proper installation. Designer Series Components are designed to Match with our Stainless Steel Cabinet Islands.

## PLACING:

All Designer Doors are "Self-Rimming", meaning that whatever the Cut-Out edge looks like, as it is always rough, the product rim will cover all edges. Specific to Designer Doors.

1. Follow Cut-Out dimensions provided on product Specification sheet, after removing door from packaging, insert door frame in to cut-out of island wall.

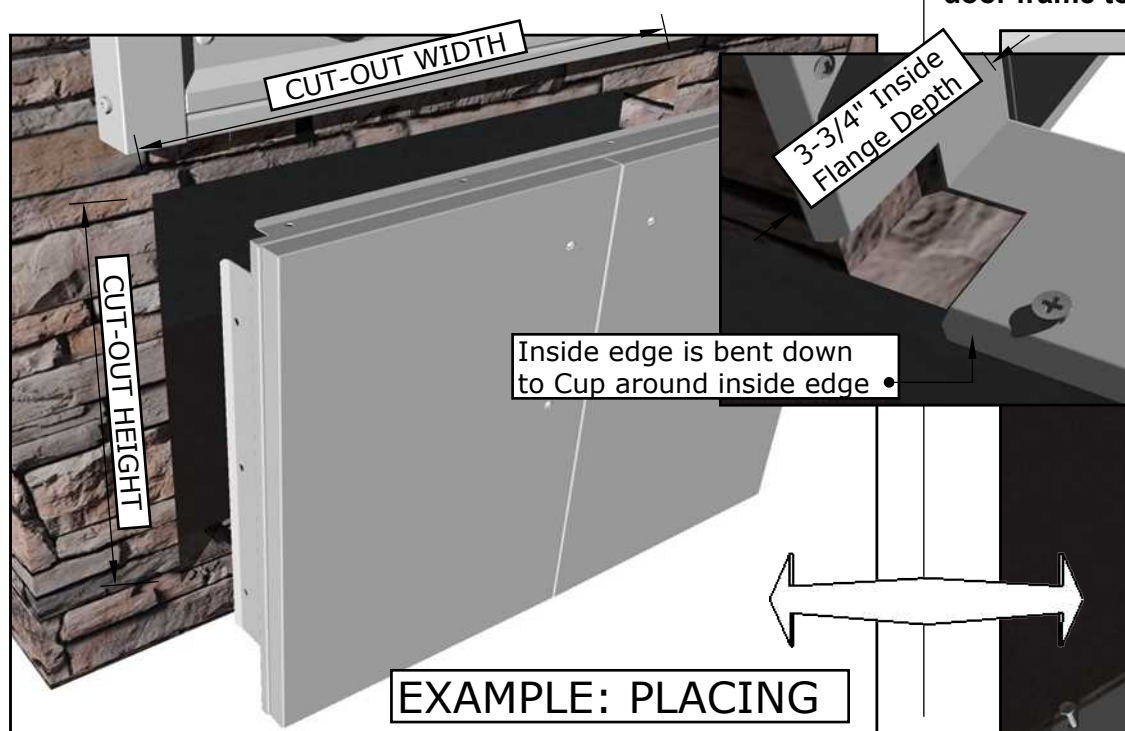

## MOUNTING:

2. Open Doors, locate the small pre-drilled holes, see small bend on inner flange, this cups around inside edge, or push into inner cut-out frame wall securing door. Match screw type or installation type to your "Type of Installation Method" listed below. For Wood use Deck Screws, Metal Studs use Self-Tapping Screws, Masonry either use Concrete Bolt - or Concrete, careful - some types may make it difficult to remove door if needed. **Use Clear Silicone around outside edge of door frame to seal against water moisture and rain.**

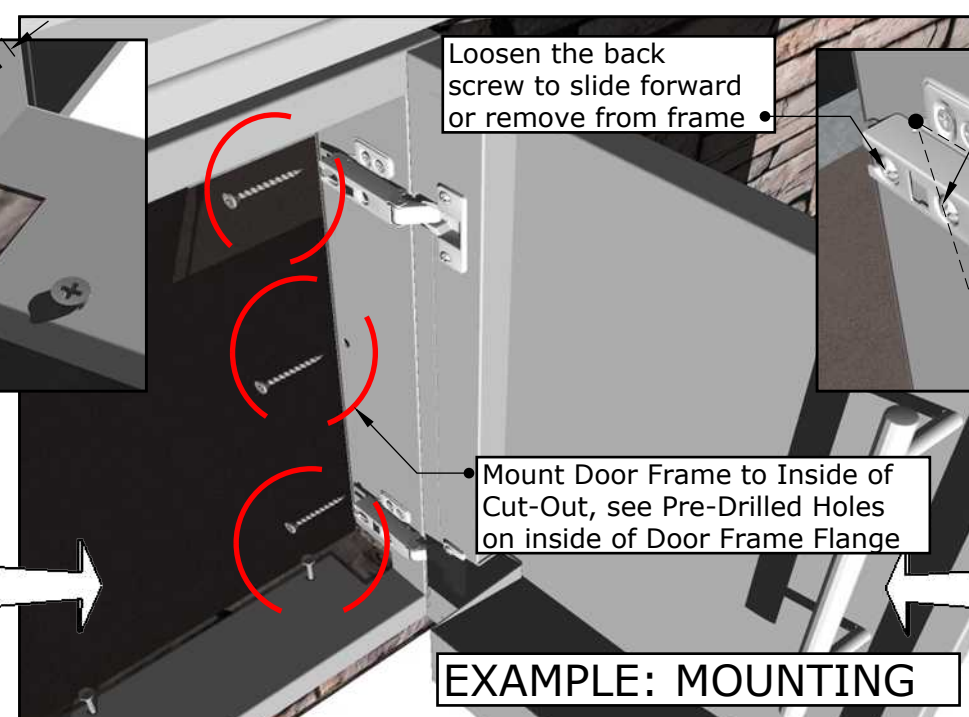

## ADJUSTING:

3. Handles are mounted to inside of door frame, remove these and re-mount to outside of each door, careful not to scratch the finish with tip of screw driver. If doors are uneven adjust door hinge with Screw driver, adjust the back screw to move door closer or further from frame, this is also the screw to remove the door from frame, or hinge if needing replaced. Adjust Center Screw to elevate hinge away from frame.

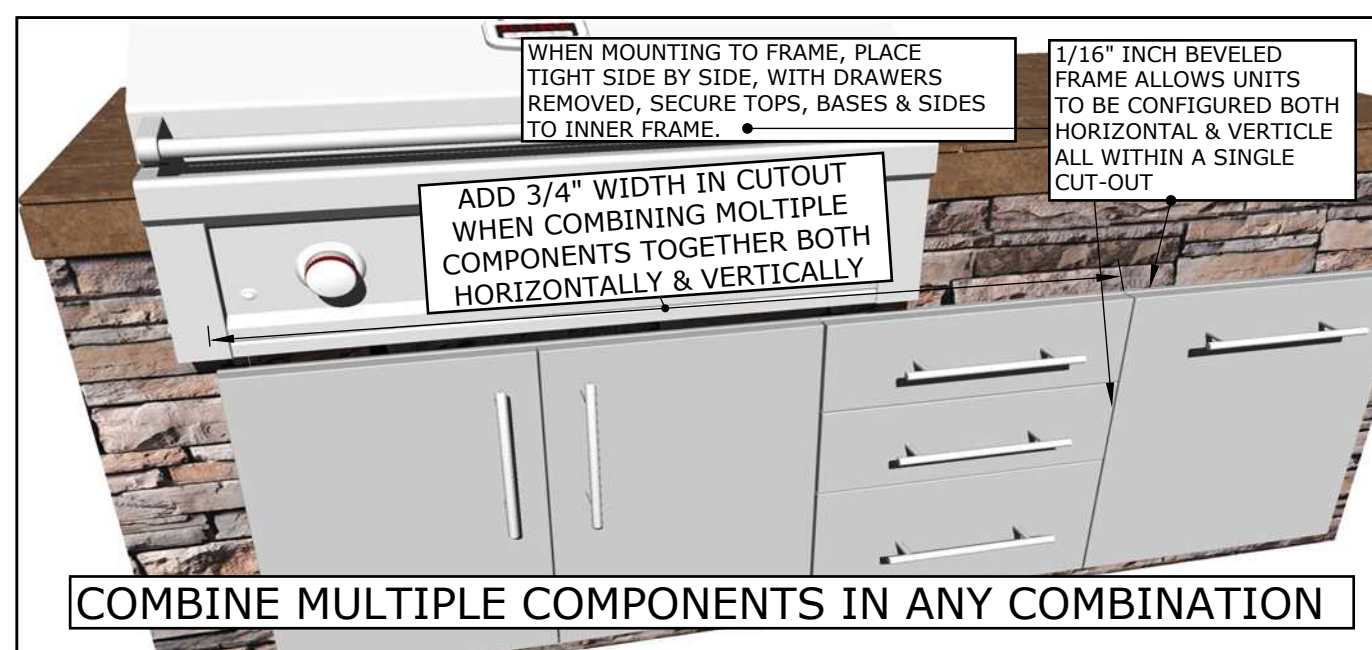
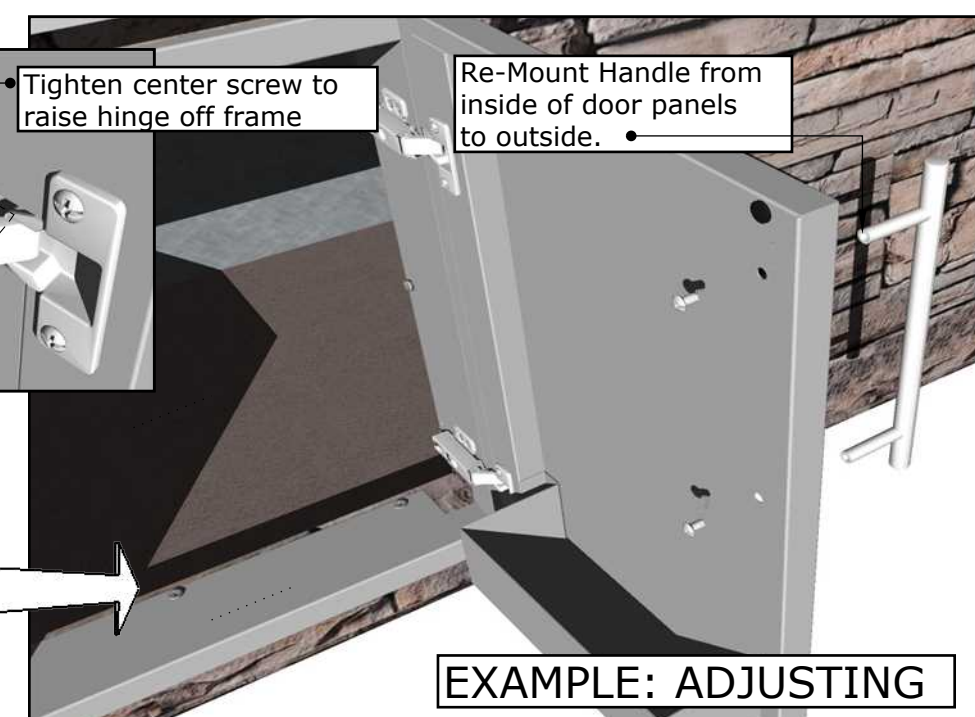

## TYPES OF INSTALLATION METHODS

- WOOD FRAMED ISLAND:** For Wood Framed Island Construction is Extremely important Not to use any wood within 24" Inches of BBQ Grills. Wood frame is fine for Bar/Sink areas and or Storage compartments. If your island is mostly wood, just substitute for Metal Studs while within the 24" Inches of BBQ Grill. When installing Door to all Wood Framed Islands, locate the Pre-Drilled holes on the inside rim of Door perimeter. Locate some "Deck Screws" in your hardware section of **HOME DEPOT**.
- METAL STUD FRAMED ISLAND:** This is the most common type of Outdoor Kitchen Island, for most "Modular Type" Islands, and even many islands built on-site use Metal Studs as their choice of construction material. It is a superb building material for many reason, easy to work with, fire-proof, and sturdy as it is available in many Gauge thickness for whatever the use. When installing your Door with this type of construction, you will need to use a "Self-Tapping Screw's" - which are available in plastic boxes usually in the Hardware section of your **HOME DEPOT** store.
- MASONRY CONCRETE BLOCK ISLAND:** The use of Masonry materials is very common among Contractors/Pool Builders, who use materials like Cinder Blocks very often preferring this type of construction for it's Low-Cost attributes and easier building methods. If your Island is built in this way, you must pay closer attention to the Cut-Out Width & Height, since the average Block Height is 4", 8" or 12" Inches and will not allow for any variance to these measurements without actually cutting into the stone. Use a Hammer-Drill and a Concrete Drill Bit to make the Holes, then use the Hammer-Drill once again this time using a Self-Tapping Concrete Bolt. Other methods include using the masonry's concrete mortar around back frame of door, or even using "Nail-Glue", important note - for either of these other methods you will not be able to remove your door later if needed. Locate The Hammer-Drill, Concrete Drill Bit in the Hardware Section, or Concrete & Masonry Blocks in the Building Materials Section of your local **HOME DEPOT** store.